

THESE DRAWINGS AND SPECIFICATIONS ARE THE PROPERTY OF JBL INCORPORATED. THEY ARE ISSUED IN STRICT CONFIDENCE AND SHALL NOT BE REPRODUCED OR USED AS THE BASIS FOR MANUFACTURE OR APPARATUS WITHOUT WRITTEN PERMISSION.

ALL MATERIAL SPECIFIED ON THIS DRAWING SHALL COMPLY WITH EUROPEAN DIRECTIVE 2002/95/EC. [0013]

REVISIONS					
CHG	LTR	DESCRIPTION	DEPT	D/C	DATE
	A	RELEASE TO MARKETING	TH		
					SO

4

3

2

1

D

8

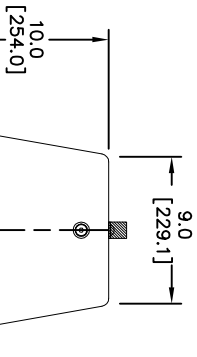

8

TOP

C

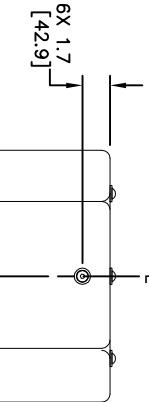

8

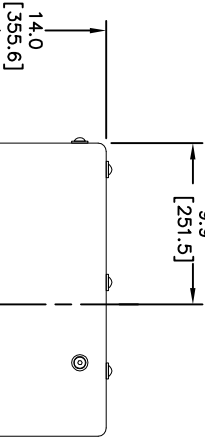

C

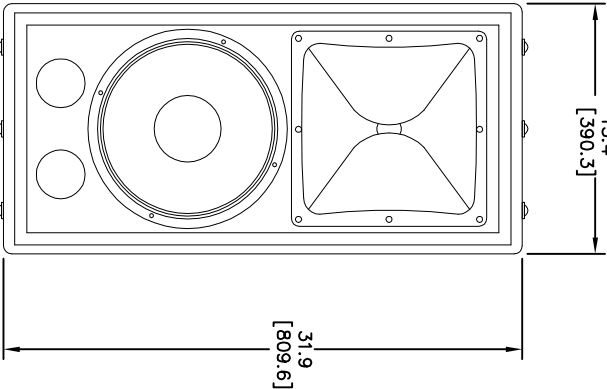

REAR

SIDES

FRONT

B

8 INDICATED DIMENSIONS ARE TO CENTER OF GRAVITY (CG). [Symbol]

7. WEIGHT: 32.7 KG [72 LBS].
6. SUSPENSION POINTS: M10 THREADED SUSPENSION POINTS, 4X TOP, 4X BOTTOM, 2X LEFT, 2X RIGHT, 2X REAR
5. COMPONENTS: LF – 2262HPL
HF – 2432H
4. INPUT CONNECTORS: 20' DIRECT BURIAL CAPTIVE CABLE.

A

3. GRILL: 16 GA. VINYL DIPPED STAINLESS STEEL GRAY WITH BLACK FOAM BACKING AND VAPOR BARRIER.
2. MATERIALS: 5/8 INCH BIRCH PLYWOOD.
1. FINISH: GRAY FIBERGLASS (STD)
(WHITE & BLACK AVAILABLE BY CUSTOM ORDER)

NOTES: (UNLESS OTHERWISE SPECIFIED)

TOLERANCES (UNLESS OTHERWISE SPECIFIED)	
X.XX	± .063 INCH
X.X	± .125 INCH
ANGULAR TOLERANCE OF 0±30°	
FRACTIONAL DIMENSIONS ± 1/32	
• DIMENSIONS ARE INCHES	
• ALL DIMENSIONS ARE FINISHED DIMENSIONS	
• DO NOT SCALE DRAWING	

JBL		JBL PROFESSIONAL	
		A Harman International Company	
		Northridge, California 91329 U.S.A.	

TITLE			
AM7212/XX-WRX CUSTOMER DRAWING			
SIZE	DRAWING NO.	REV	
A	10000330126	A	
SCALE	NTS	SHEET	1 OF 1

4

3

2

1